

OPERATOR'S MANUAL

650759

INCLUDE MANUALS: 66605X-X 1/2" Diaphragm Pump (PN 97999-099)

RELEASED: 5-20-93
REVISED: 3-19-99
(REV. C)

650759 1/2" DIAPHRAGM PUMP (WITH POLYPROPYLENE FLUID SECTION)



**READ THIS MANUAL CAREFULLY BEFORE INSTALLING,
OPERATING OR SERVICING THIS EQUIPMENT.**

It is the responsibility of the employer to place this information in the hands of the operator. Keep for future reference.

Model 650759 is similar to a model 666053-0D2 diaphragm pump, therefore a 66605X-X Operator's Manual (PN 97999-099) should be used for General Information, Installation, Operation and Maintenance. This pump uses duckbill style checks.

bottom (this is the reverse of a standard pump). In addition, this pump uses a different muffler and cover.

USE SERVICE KITS:
637141 for Air Section
637140-D2 for Fluid Section

INSTALLATION NOTE: This pump has the inlet on top and outlet on the

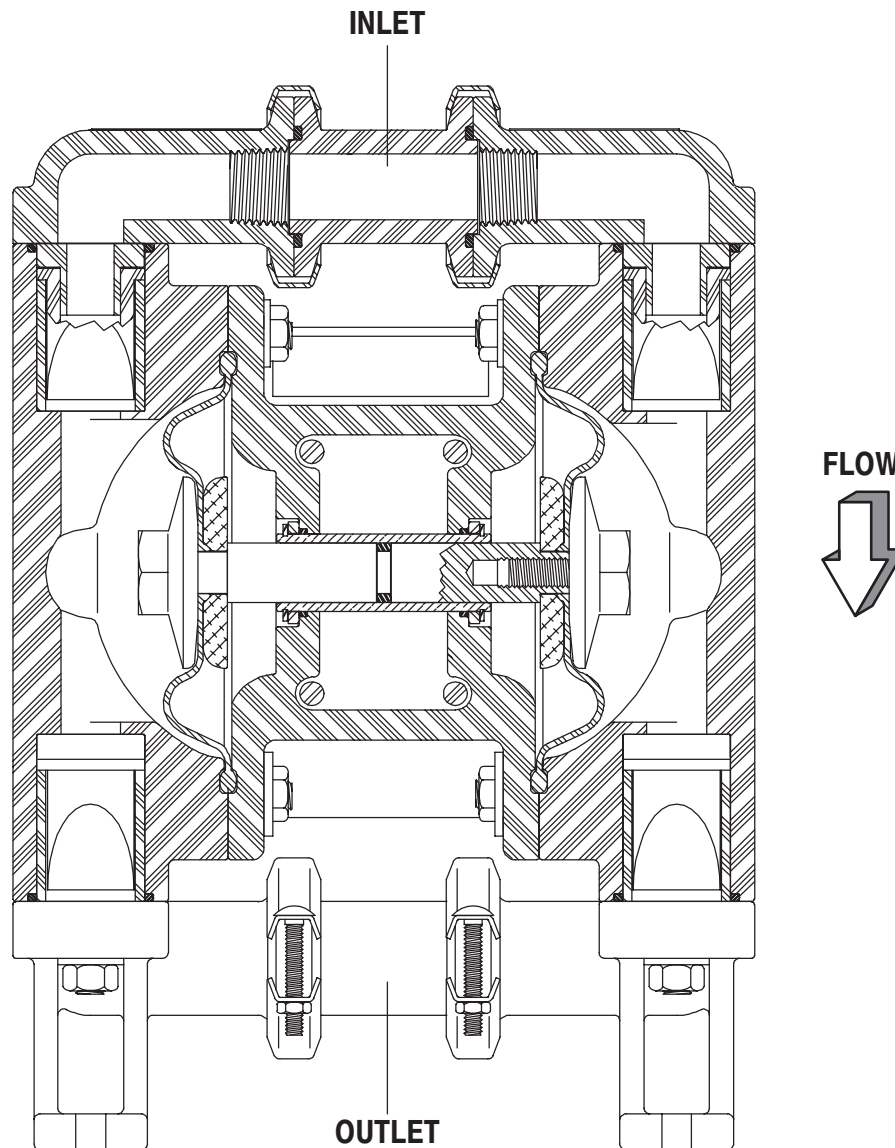

ARO

INGERSOLL-RAND COMPANY
ONE ARO CENTER • BRYAN, OHIO 43506-0151

☎ (419) 636-4242 • FAX (419) 633-1674

©1999 • PRINTED IN U.S.A.

INGERSOLL-RAND
FLUID PRODUCTS

650759 1/2" DIAPHRAGM PUMP

